

**WE CREATE LIGHT
FOR PROFESSIONALS**

CORRA
LIGHTING FACTORY

**CORRECT INSTALLATION OF LIGHTING
LED LINE LUMINAIRE**

WHAT TO LOOK OUT FOR – TRACK

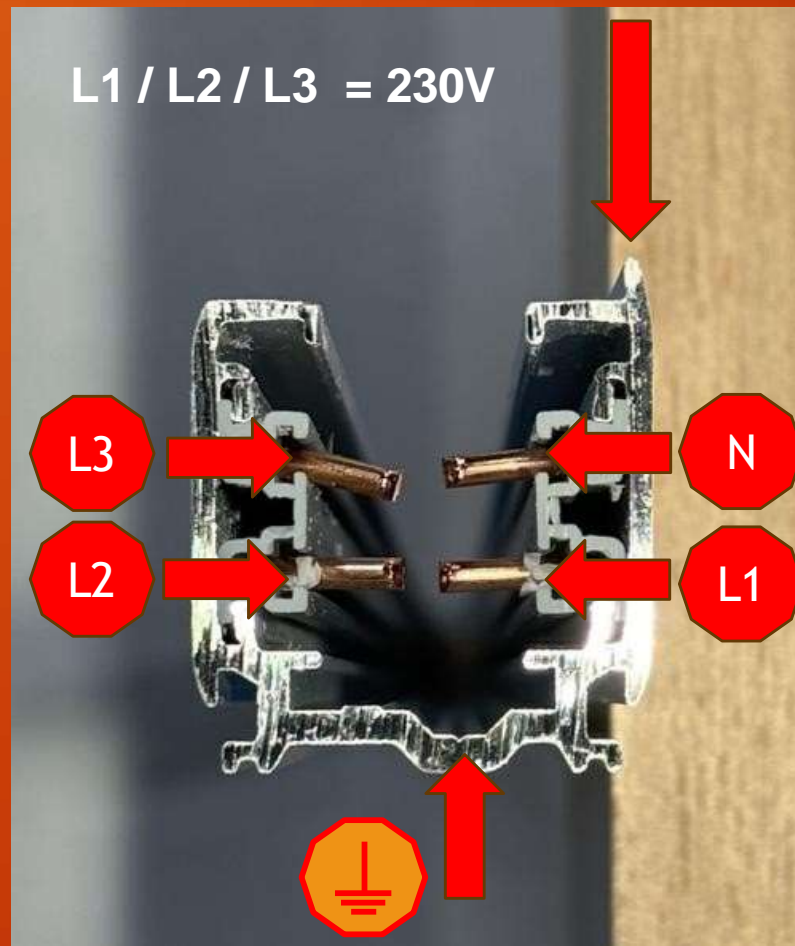
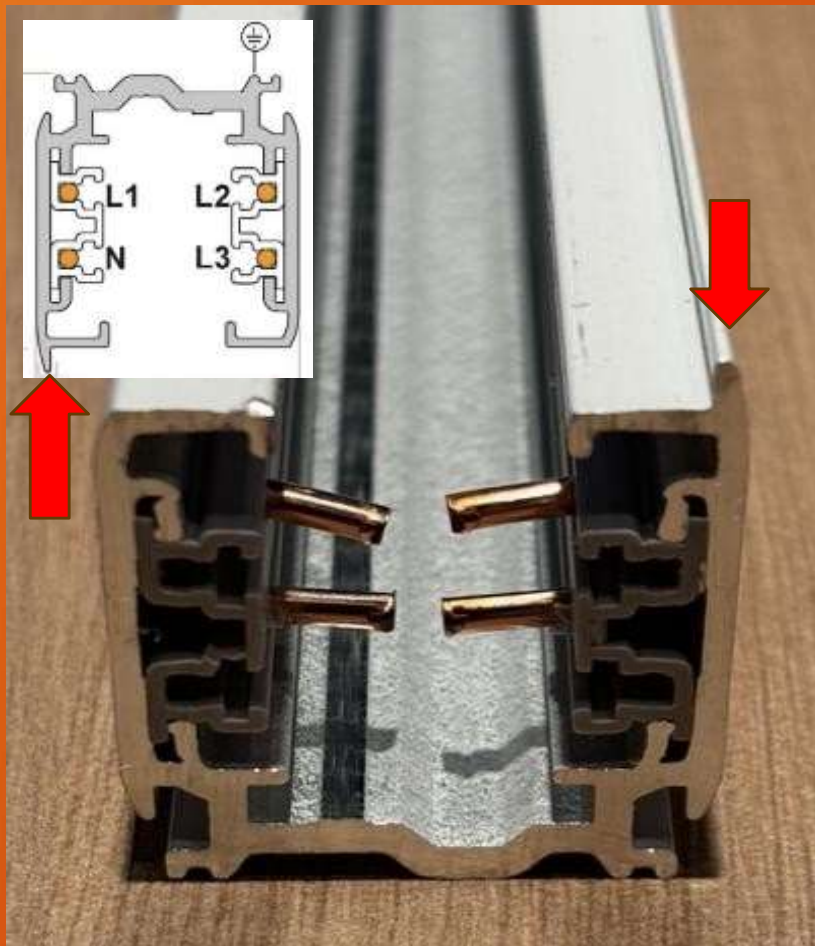

THE DESIGN OF THE TRACK IS IMPORTANT FROM THE POINT OF VIEW OF PROPER INSTALLATION OF TRACK LIGHTING

PAY ATTENTION TO THE ELEMENTS MARKED WITH AN ARROW

WHAT TO LOOK OUT FOR - THE ADAPTOR

CORFA
LIGHTING FACTORY

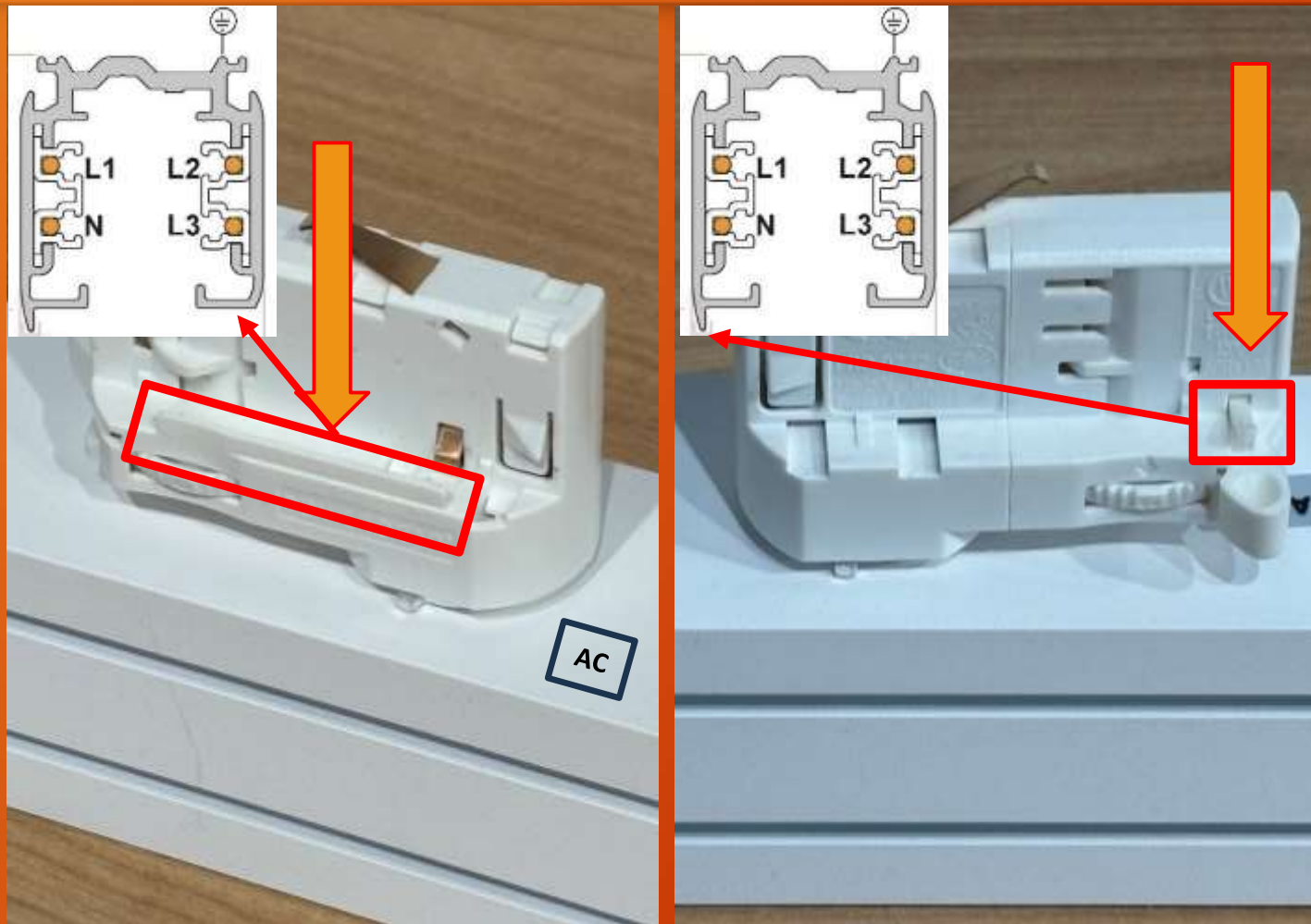

PAY ATTENTION TO THE DESIGN OF THE ADAPTOR. ITS CONSTRUCTION IS VERY IMPORTANT IN THE CORRECT INSTALLATION OF LIGHTING IN A TRACK.

PAY ATTENTION TO THE ELEMENTS MARKED WITH AN ARROW

WHAT TO LOOK OUT FOR WHEN FITTING LED LINE TO A TRACK

CORFA
LIGHTING FACTORY

POWER SUPPLY ADAPTOR

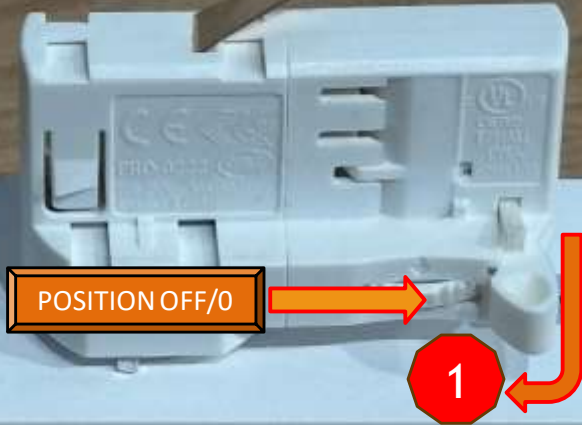

STABILISATION ADAPTOR

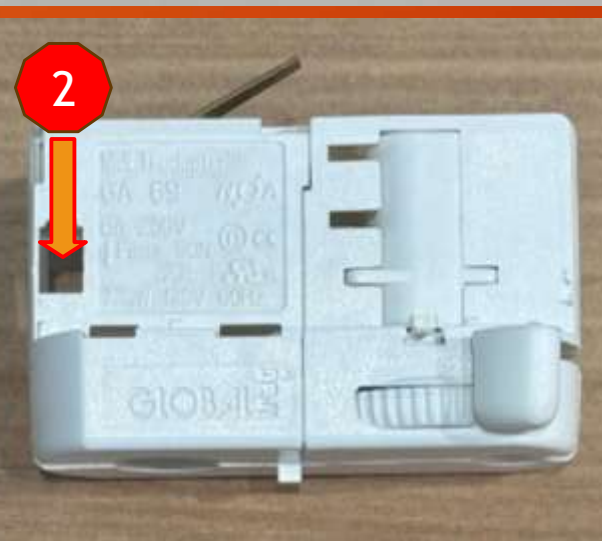
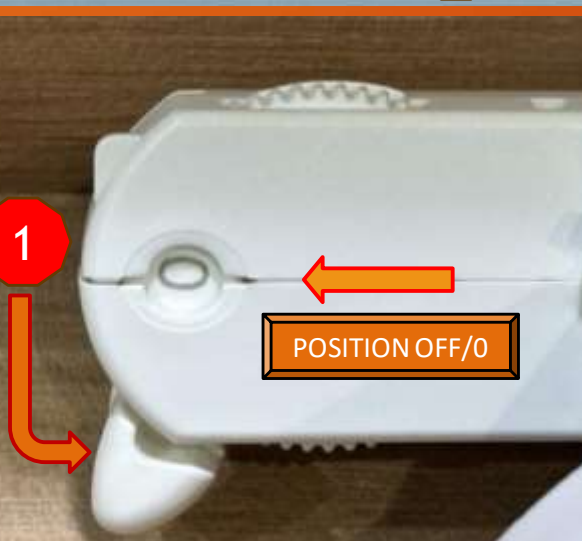

BEFORE INSTALLING THE LED LINE LUMINAIRE ON THE TRACK CHECK THE ADAPTOR SETTINGS:

1. ADAPTOR PROTECTION ARM – 1 MUST BE IN THE OPEN POSITION,
2. THE ADAPTOR MUST BE IN THE OFF / 0 POSITION,
3. THE POWER SUPPLY AND STABILISING ADAPTOR MUST BE ORIENTED IN THE SAME DIRECTION IN RELATION TO THE TRACK,
4. THE STABILISER ADAPTOR ALWAYS HAS THE LOCKS REMOVED - 2

PAY ATTENTION TO THE ELEMENTS MARKED BY ARROWS

WHAT TO LOOK OUT FOR WHEN INSTALLING LED LINE FIXTURES ON A TRACK

CORFA
LIGHTING FACTORY

CORRECT INSTALLATION OF AN LED LINE LUMINAIRE ON A TRACK COMBINES THE FOLLOWING STEPS:

1. OPENING OF THE PROTECTION ARM - 1 IN BOTH ADAPTORS,
2. ADAPTOR RAIL - 2 FOR ADAPTOR CONSTRUCTION - 3,
3. LOCKING OF THE PROTECTION ARM - OF BOTH ADAPTORS - 1, AFTER PROPER INSERTION IN THE RAIL - CABLE.,

NOTE: THE BUSBAR SHOULD BE FIXED WITHOUT THE USE OF FORCE.

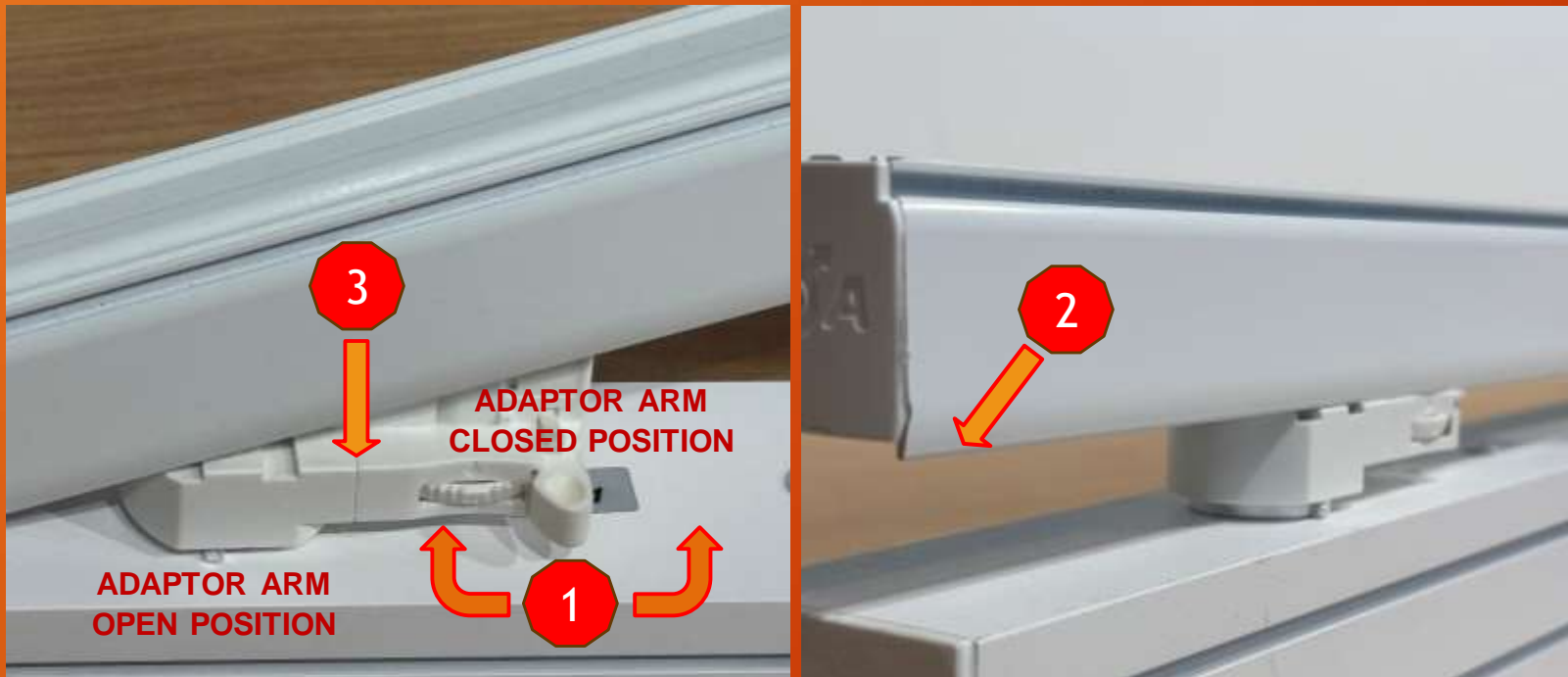

PAY ATTENTION TO THE ELEMENT MARKED BY THE ARROWS

WHAT TO LOOK OUT FOR WHEN INSTALLING LED LINE FIXTURES ON A TRACK

CORFA
LIGHTING FACTORY



AFTER THE LED LINE LUMINAIRE HAS BEEN
CORRECTLY INSTALLED IN THE TRACK

WITH THE ROTARY KNOB - CHANGE THE PHASE

ALTERNATE PHASE 1 / 2 / 3 TO AVOID LOADING OF
THE SAME PHASE

**PLUGGING THE ADAPTORS INTO THE BUS DUCT
IN THE OPPOSITE WAY TO THE ONE SHOWN IN
THE INSTRUCTIONS WILL RESULT IN PERMANENT
DAMAGE TO THE LUMINAIRE WITH NO
POSSIBILITY OF GUARANTEE REPAIR.!**

**PAY ATTENTION TO THE ELEMENTS
MARKED BY THE ARROWS**